

# Quick Start Guide

Indoor/Outdoor Pan/Tilt  
Security Wi-Fi Camera

\*Images may differ from actual products.  
©2025 TP-Link 7106511820 REV1.0.0

## 01 / Set Up Your Camera

### 1. Download the App

Get the **Tapo** app from the App Store or Google Play, and log in.



### 2. Set Up

Tap the **+** button > Add Device in the app and select your model. Follow the app instructions to set up your camera.

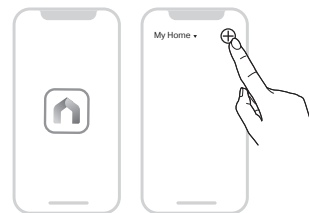

## 02 / Installation Options

### 1. Set on a Table or Shelf

Place the camera on a flat surface like a table or shelf.

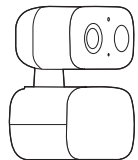

### 2. Mount on a Wall, Ceiling, or Pole

The bracket is designed for multiple mounting methods. Choose your preferred one and refer to the instructions on the following pages.

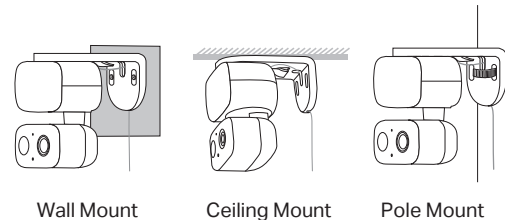

Wall Mount

Ceiling Mount

Pole Mount

## 03 / Mount Your Camera

### Option 1: Wall Mount

#### 1. Drill Holes

Stick the mounting template to the desired mounting place. Drill **two** screw holes according to the template.

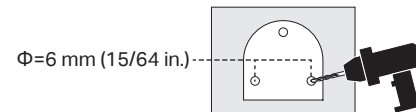

#### 2. Route the Power Cord

Route the power cord through the opening at the bracket's bend.

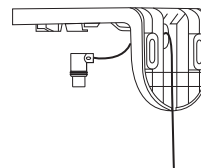

#### 3. Install the Bracket

Insert two anchors into the holes and use the screws to affix the bracket over the anchors. Plug the Type-C connector into the camera base.

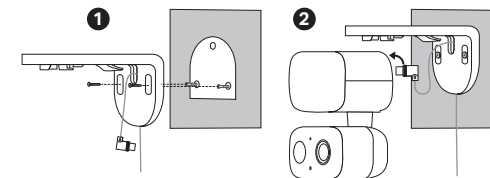

#### 4. Secure the Camera

Align the snap-fit and slide the camera base onto the bracket from the inside outward until it clicks securely into place.

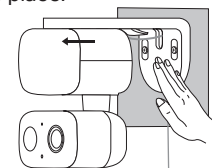

### Option 2: Ceiling Mount

#### 1. Drill Holes

Stick the mounting template to the desired mounting place. Drill **three** screw holes according to the template.

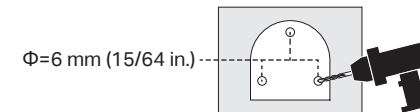

#### 2. Route the Power Cord

Route the power cord through the opening at the bracket's bend.

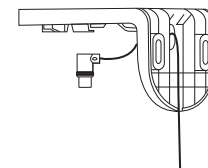

#### 3. Install the Bracket

Insert three anchors into the holes and use the screws to affix the bracket over the anchors. Plug the Type-C connector into the camera base.

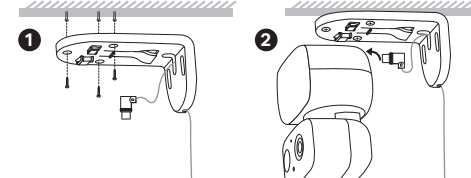

#### 4. Secure the Camera

Align the snap-fit and slide the camera base onto the bracket from the inside outward until it clicks securely into place.

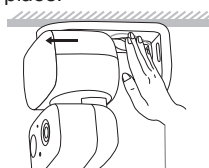

# 03 / Mount Your Camera

## Option 3: Pole Mount

### 1. Route the Power Cord

Route the power cord through the opening at the bracket's bend.

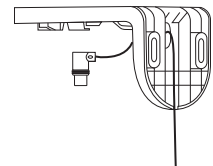

### 2. Install the Bracket

Mount the bracket on the pole using one pole-mounting loop\* (loop width ≤ 12 mm).

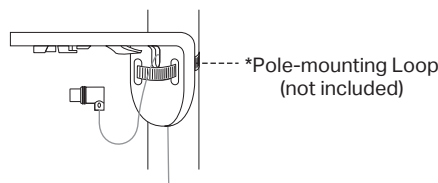

### 3. Secure the Camera

Plug the Type-C connector into the camera base. Align the snap-fit and slide the camera base onto the bracket from the inside outward until it clicks securely into place.

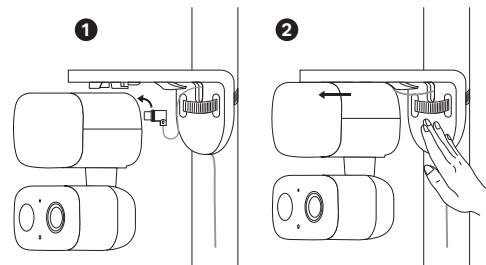

## How to Detach the Camera

Press the safety clip and slide the camera base out of the bracket, moving from the outside in.

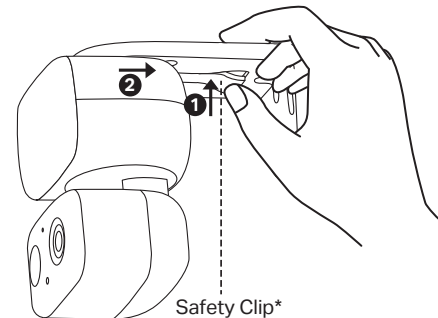

\*The safety clip is designed to prevent falling off in extreme weather.



For technical support, user guides, FAQs, warranty, and more, please visit [www.tapo.com/support/](http://www.tapo.com/support/)



## Appearance

### Front

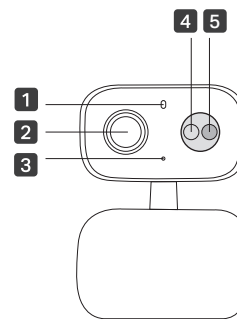

- 1 System LED
- 2 Lens
- 3 Microphone
- 4 IR LED
- 5 White Light LED

### Back

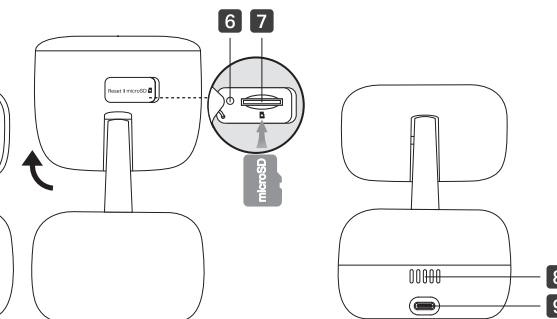

\*Rotate the camera body up and open the silicone cover to find the reset button and microSD card slot.

- 6 Reset Button
  - Use a pin to press and hold for 5s: Reset Wi-Fi settings
  - Use a pin to press and hold for 10s: Reset to factory settings
- 7 microSD Card Slot
  - Insert a microSD card (not included) and initialize it on the Tapo app for local recording.



- 8 Speaker
- 9 USB Type-C Power Port

## System LED Indication

Solid red	Starting up
Blinking red and green	Ready for setup
Blinking red slowly	Connecting to Wi-Fi
Solid amber	Connected to Wi-Fi
Solid green	Connected to the cloud
Blinking red quickly	Camera resetting
Blinking green quickly	Camera updating

### Safety Information

- Adapter shall be easily accessible.
- Never touch the product with wet hands.
- Do not disassemble, repair or modify the product.
- Do not use any other chargers than those recommended.
- Do not use the device where wireless devices are not allowed.
- Do not use damaged charger or USB cable to charge the device.
- Do not use the product if the casing has been broken. Danger of electric shock.
- Keep the device away from fire or hot environments. DO NOT immerse in water or any other liquid.
- Use only power supplies which are provided by manufacturer and in the original packing of this product. If you have any questions, please don't hesitate to contact us.



- Do not place near automatically controlled devices such as fire alarms. Radio waves emitted from this product may cause such devices to malfunction resulting in an accident.
- Observe restrictions on using wireless products in fuel depots, chemical plants or when blasting operations are in progress.
- Do not use liquid to clean the product. Only use a dry cloth.
- Never put metal objects inside the product. If a metal object enters the product turn off the circuit breaker and contact an authorised electrician.
- This product is not intended to be used when providing medical care. Consult the manufacturer of any personal medical devices, such as pacemakers or hearing aids to determine if they are adequately shielded from external RF (radio frequency) energy.
- Do not use this product in health care facilities. Hospitals or health care facilities may be using equipment that could be sensitive to external RF energy.
- Do not place heavy objects on top of the product.
- When you leave the product unused for a long time unplug the product from the power outlet.
- This product may interfere with other electronic products such as TV, radios, personal computers, phones or other wireless devices.
- Adapter should be used indoors where the ambient temperature is lower than or equal to 40 °C.
- Operating Temperature: -20 °C ~ 50 °C (-4 °F ~ 122 °F)
- It is recommended to install the camera no higher than 2 meters. Please read and follow the above safety information when operating the device. We cannot guarantee that no accidents or damage will occur due to improper use of the device. Please use this product with care and operate at your own risk.

TP-Link hereby declares that the device is in compliance with the essential requirements and other relevant provisions of directives 2014/53/EU, 2009/125/EC, 2011/65/EU and (EU)2015/863. The original EU declaration of conformity may be found at <https://www.tapo.com/support/ce>

TP-Link hereby declares that the device is in compliance with the essential requirements and other relevant provisions of the Radio Equipment Regulations 2017. The original UK declaration of conformity may be found at <https://www.tapo.com/support/ukca/>